

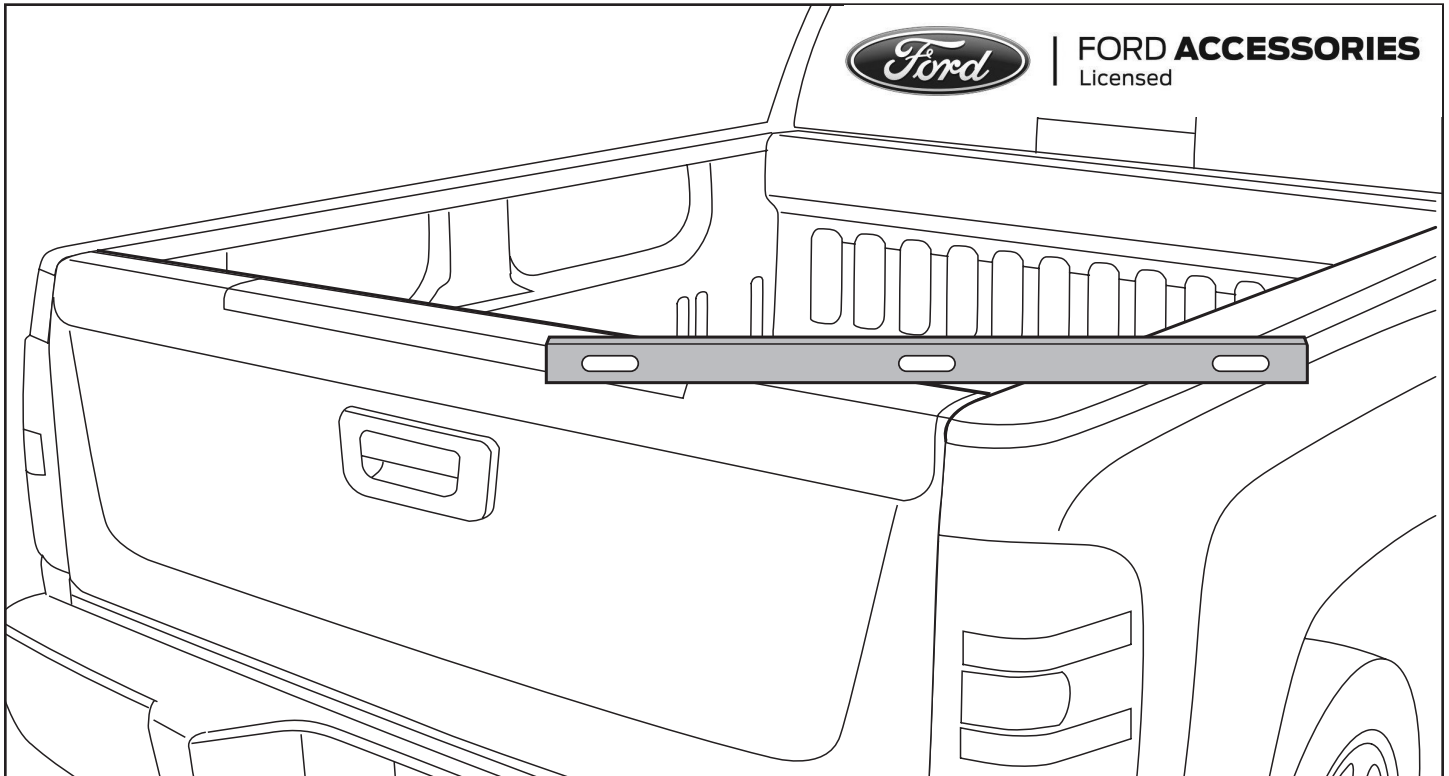

IMPORTANT: READ FIRST



2015+ TONNEAU COVER INSTALLATION ADDENDUM



IMPORTANT NOTE: If the truck is equipped with a remote release tail gate, the tail gate must first be checked for “Nominal or Flush” condition with a “straight edge” from side to side. If it is found to be “higher than flush” the tail gate must be adjusted prior to the Tonneau cover being installed. If the tail gate is found to be “higher than flush” the owner must return the vehicle to the dealer for adjustment.

SEE ILLUSTRATIONS ABOVE:

If you choose to install a tonneau cover yourself, you must first follow the same process mentioned above.

IMPORTANT : Si le camion est doté d'un hayon à commande à distance, il importe d'abord de bien vérifier son alignement « nominal ou affleurant » à l'aide d'une « règle de vérification » d'un côté à l'autre. Si le hayon est « plus haut que le niveau affleurant », il doit être ajusté avant d'installer le couvercle de plateau. Si tel est le cas, le propriétaire doit ramener le véhicule chez le concessionnaire pour faire effectuer l'ajustement.

VOIR ILLUSTRATIONS CI-DESSUS :

Si vous choisissez de poser le couvercle de plateau vous-même, vous devez d'abord effectuer l'ajustement décrit ci-dessus.

NOTA IMPORTANTE: Si el camión está equipado con una puerta trasera de liberación remota, la puerta trasera debe ser chequeada primero por condición “superior o al ras” con una “regla recta” de lado a lado. Si se encuentra “superior al nivel”, la puerta trasera debe ajustarse antes de ser instalada la cubierta. Si la puerta trasera se encuentra “por encima del nivel”, el propietario debe devolver el vehículo al distribuidor para el ajuste.

VEA LAS ILUSTRACIONES MÁS ABAJO:

Si usted decide instalar una cubierta; deberá primero seguir el mismo proceso mencionado anteriormente.



IMPORTANT: READ FIRST

2015+ TONNEAU COVER INSTALLATION ADDENDUM

IMPORTANT NOTE TO INSTALLER

After installation of tonneau cover, if truck is equipped with power tailgate release, please cycle tailgate no less than 5 times to assure proper function. If tailgate should not release re-adjust tonneau cover and or tailgate and cycle again, tailgate must drop down without any restrictions.

REMARQUE IMPORTANTE DESTINÉE À L'INSTALLATEUR

Après l'installation du couvre-caisse, si le camion possède un déverrouillage de hayon électrique, veuillez actionner le hayon au moins cinq fois pour en vérifier le bon fonctionnement. Si le hayon ne s'ouvre pas, réajuster le couvre-caisse ou le hayon et actionner à nouveau le système. Le hayon doit s'ouvrir sans obstruction.

AVISO IMPORTANTE PARA EL INSTALADOR

Después de la instalación de la cubierta Tonneau, si la camioneta cuenta con apertura y cierre eléctrico de la compuerta trasera, abra y cierre la compuerta trasera no menos de 5 veces para garantizar su correcto funcionamiento. Si la compuerta trasera no se abre, reajuste la cubierta Tonneau o la compuerta trasera, y ábrala y ciérrala otra vez; la compuerta trasera debe bajar sin ninguna restricción.

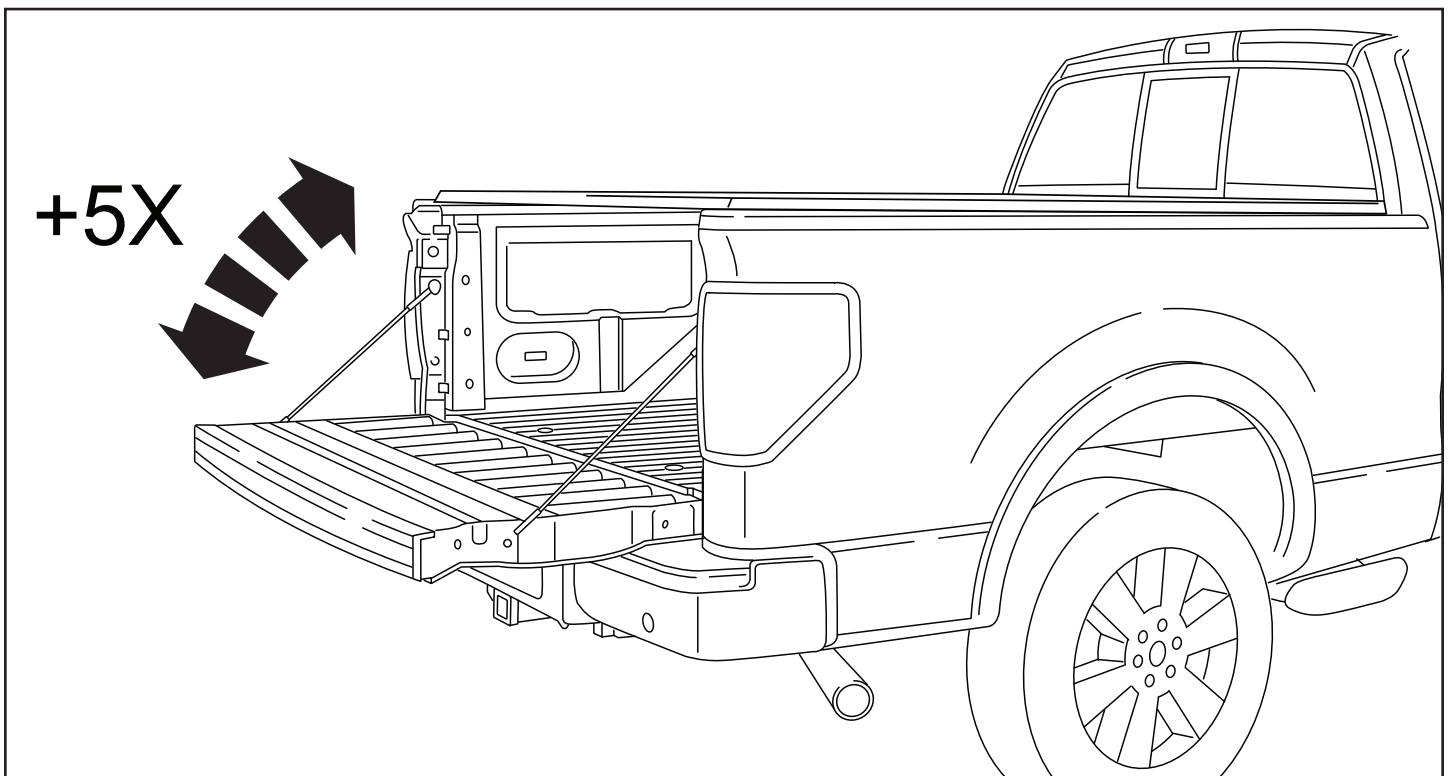

INSTALLATION SHEET

Any damaged or missing parts?

Parts will be shipped to you directly. Call 818-365-9000, Mon - Fri
5:30 am - 4 pm Pacific Time or email support@revcovers.com

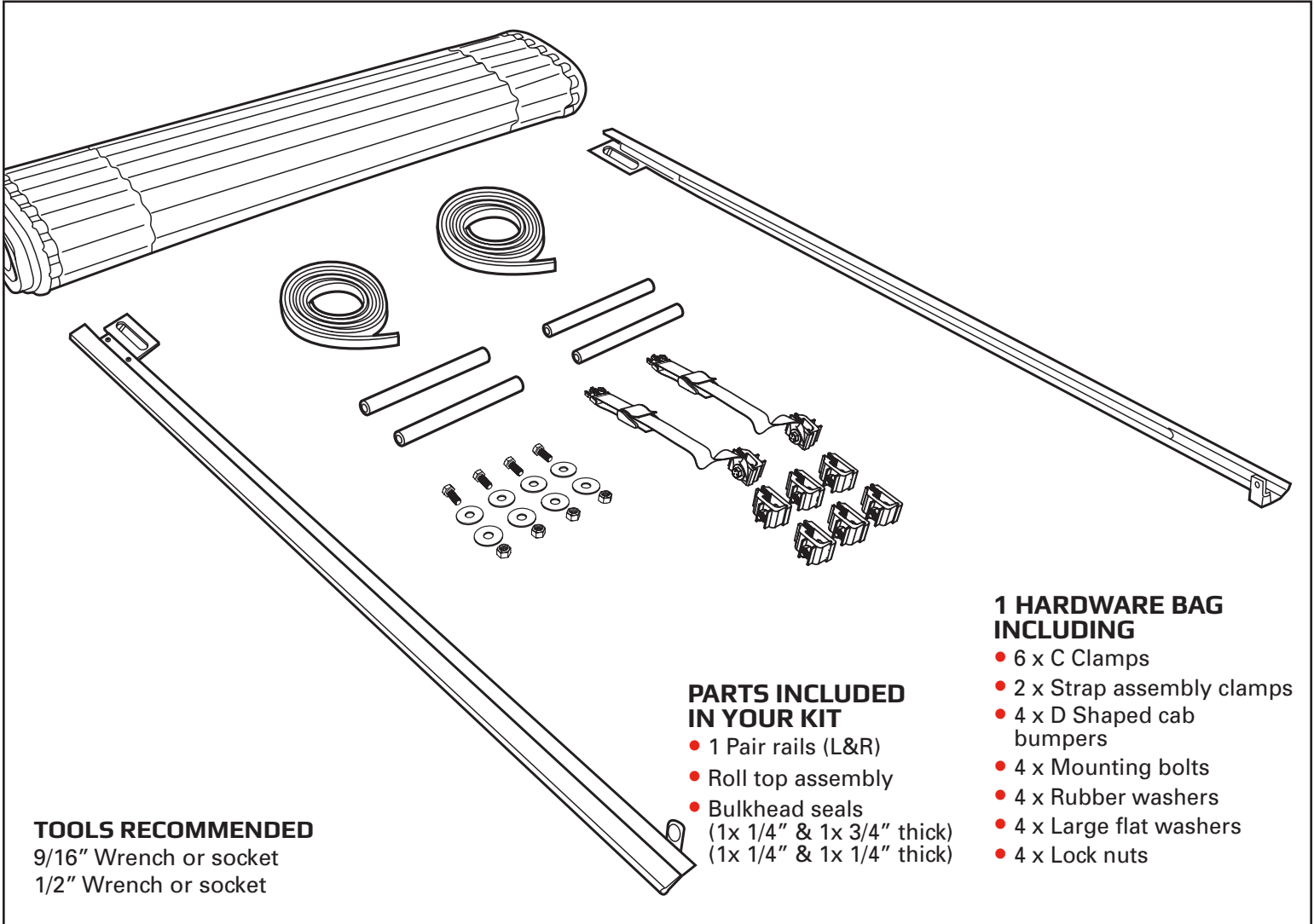

TOOLS RECOMMENDED
9/16" Wrench or socket
1/2" Wrench or socket

**PARTS INCLUDED
IN YOUR KIT**

- 1 Pair rails (L&R)
- Roll top assembly
- Bulkhead seals
(1x 1/4" & 1x 3/4" thick)
(1x 1/4" & 1x 1/4" thick)

**1 HARDWARE BAG
INCLUDING**

- 6 x C Clamps
- 2 x Strap assembly clamps
- 4 x D Shaped cab bumpers
- 4 x Mounting bolts
- 4 x Rubber washers
- 4 x Large flat washers
- 4 x Lock nuts

Positioning Your Rails

Installing the rails square to the truck bed is the key to a successful installation. Angle shims are pre-installed to the rails to ensure your rails are mounted properly.

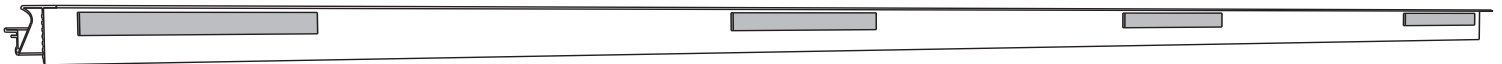

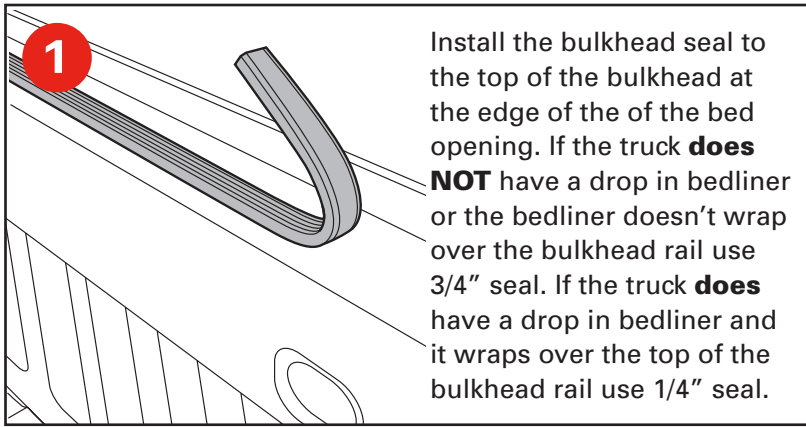

1 Install the bulkhead seal to the top of the bulkhead at the edge of the of the bed opening. If the truck **does NOT** have a drop in bedliner or the bedliner doesn't wrap over the bulkhead rail use 3/4" seal. If the truck **does** have a drop in bedliner and it wraps over the top of the bulkhead rail use 1/4" seal.

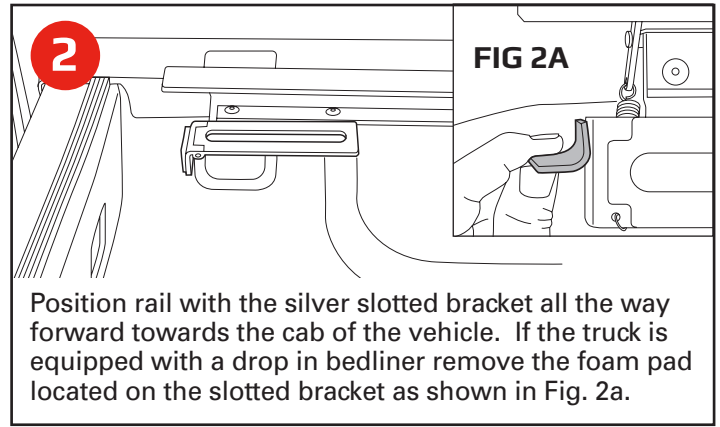

2 Position rail with the silver slotted bracket all the way forward towards the cab of the vehicle. If the truck is equipped with a drop in bedliner remove the foam pad located on the slotted bracket as shown in Fig. 2a.

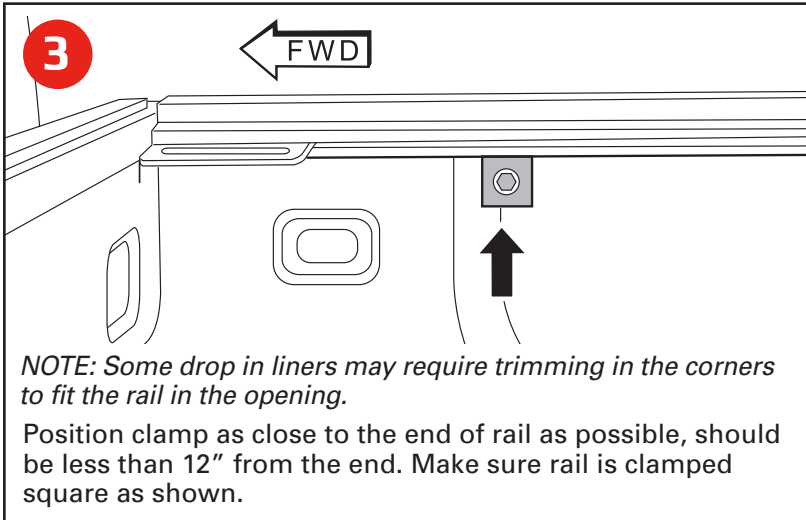

3 *NOTE: Some drop in liners may require trimming in the corners to fit the rail in the opening.*

Position clamp as close to the end of rail as possible, should be less than 12" from the end. Make sure rail is clamped square as shown.

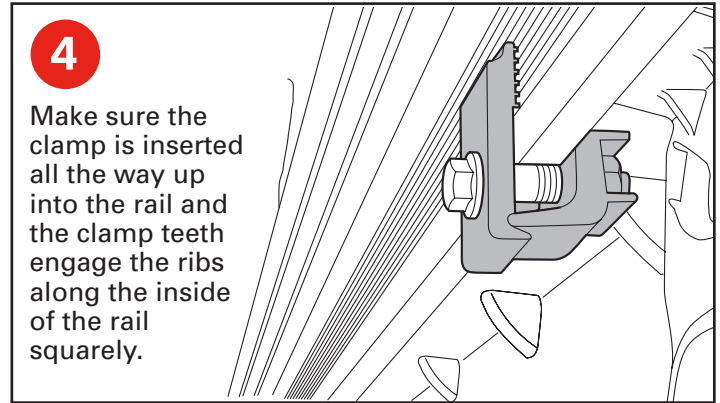

4 Make sure the clamp is inserted all the way up into the rail and the clamp teeth engage the ribs along the inside of the rail squarely.

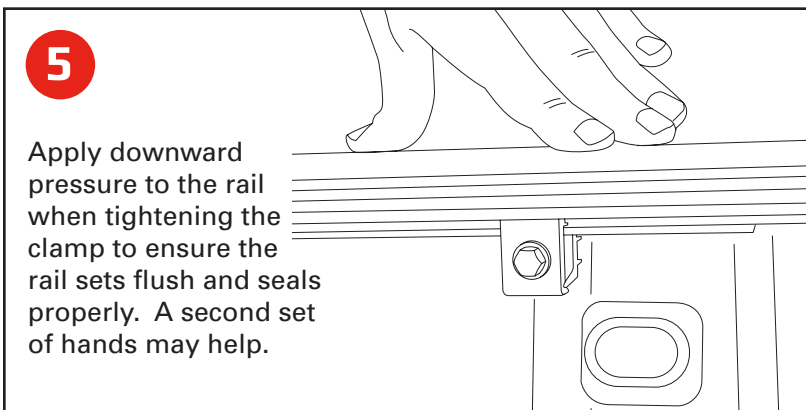

5 Apply downward pressure to the rail when tightening the clamp to ensure the rail sets flush and seals properly. A second set of hands may help.

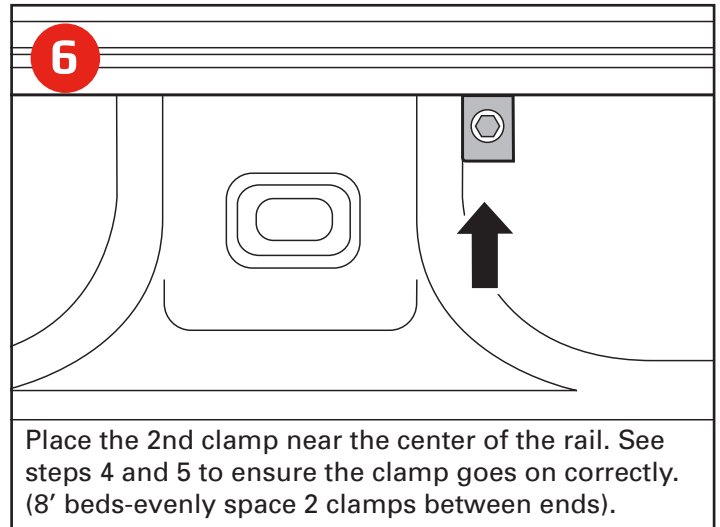

6 Place the 2nd clamp near the center of the rail. See steps 4 and 5 to ensure the clamp goes on correctly. (8' beds-evenly space 2 clamps between ends).

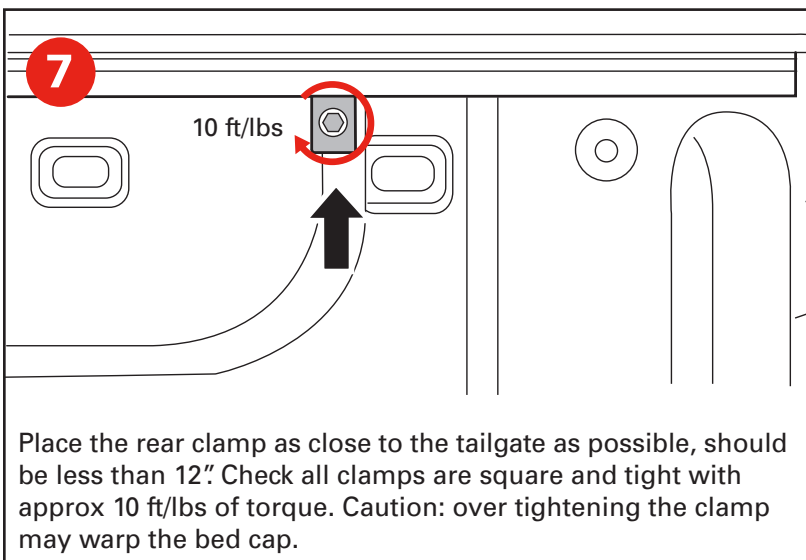

7 Place the rear clamp as close to the tailgate as possible, should be less than 12". Check all clamps are square and tight with approx 10 ft/lbs of torque. Caution: over tightening the clamp may warp the bed cap.

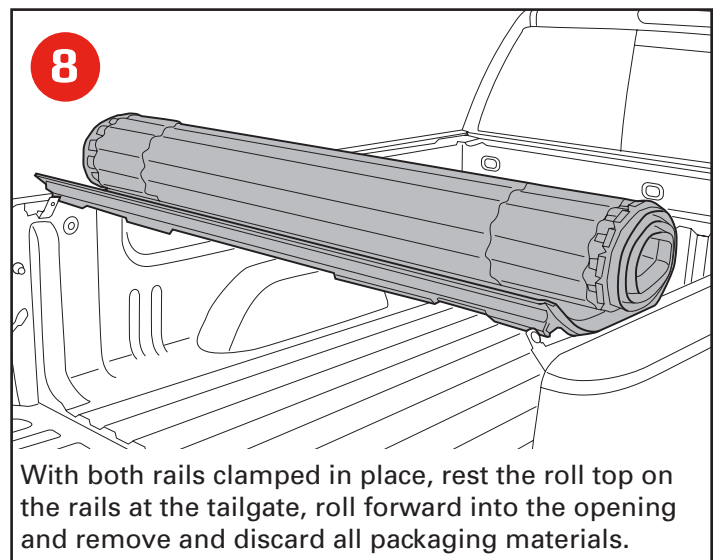

8 With both rails clamped in place, rest the roll top on the rails at the tailgate, roll forward into the opening and remove and discard all packaging materials.

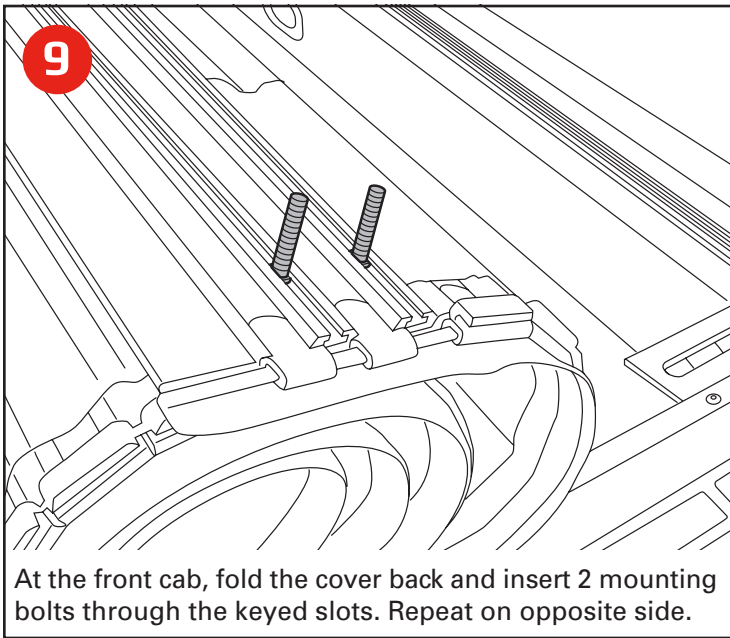

At the front cab, fold the cover back and insert 2 mounting bolts through the keyed slots. Repeat on opposite side.

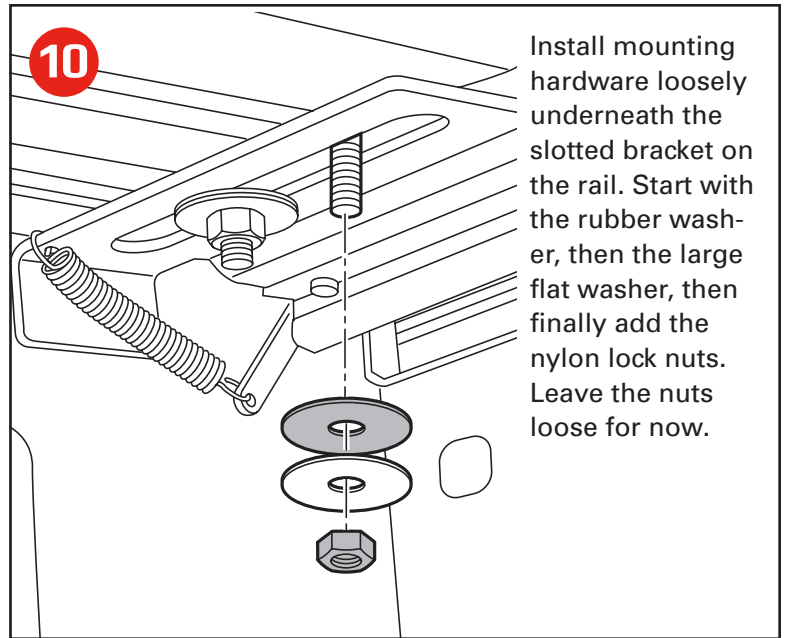

Install mounting hardware loosely underneath the slotted bracket on the rail. Start with the rubber washer, then the large flat washer, then finally add the nylon lock nuts. Leave the nuts loose for now.

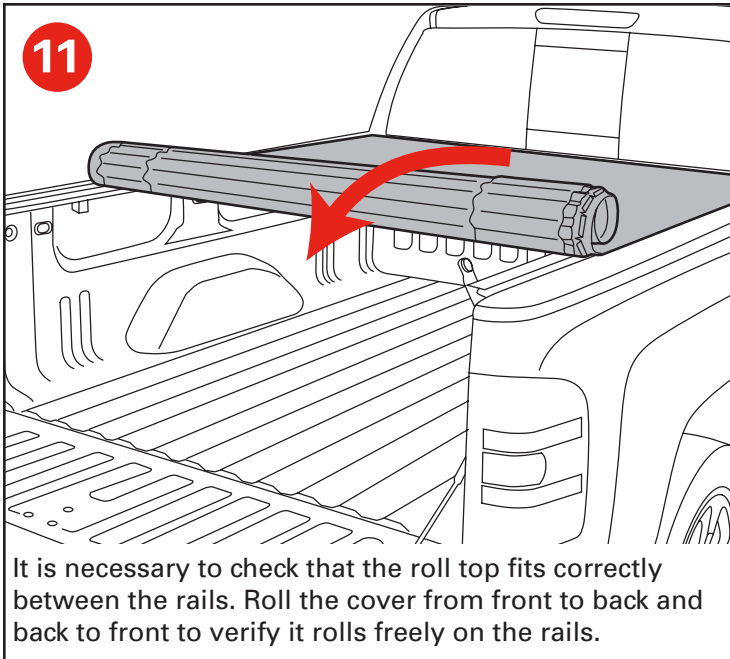

It is necessary to check that the roll top fits correctly between the rails. Roll the cover from front to back and back to front to verify it rolls freely on the rails.

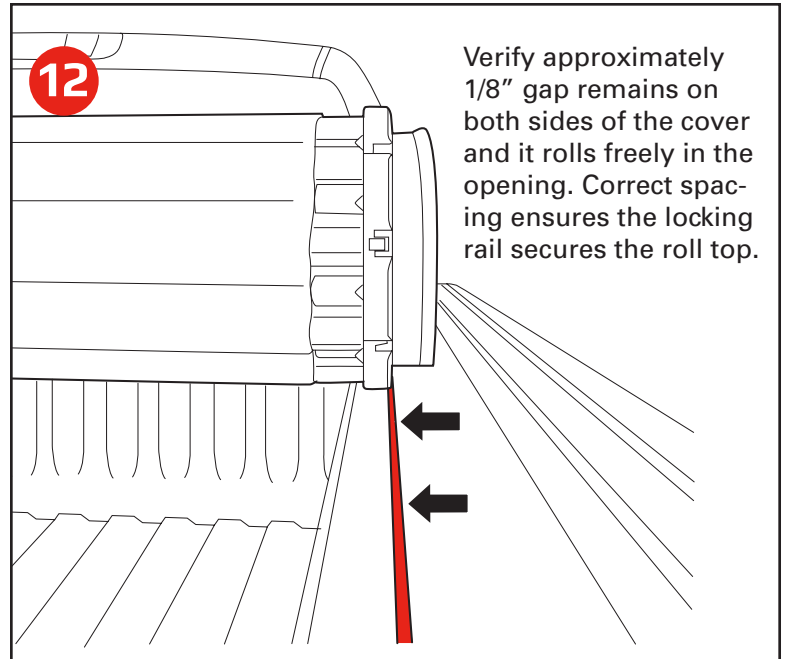

Verify approximately 1/8" gap remains on both sides of the cover and it rolls freely in the opening. Correct spacing ensures the locking rail secures the roll top.

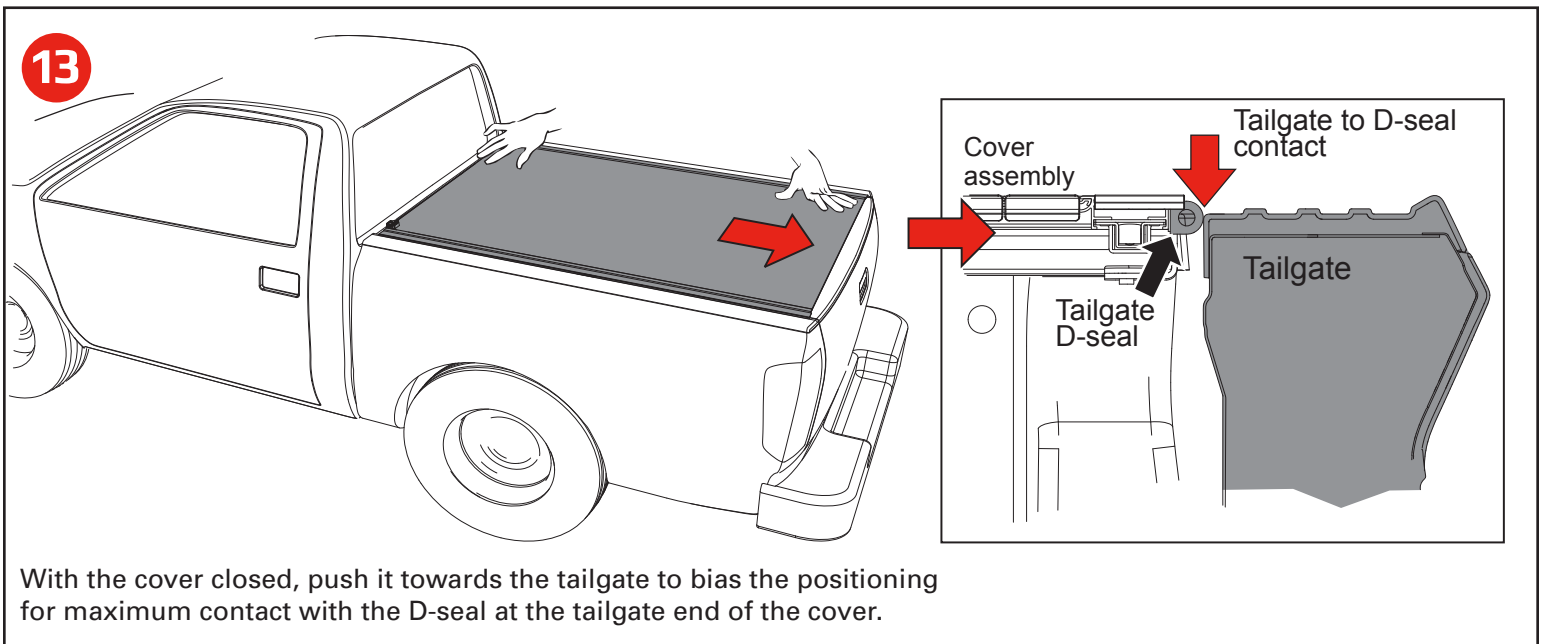

With the cover closed, push it towards the tailgate to bias the positioning for maximum contact with the D-seal at the tailgate end of the cover.

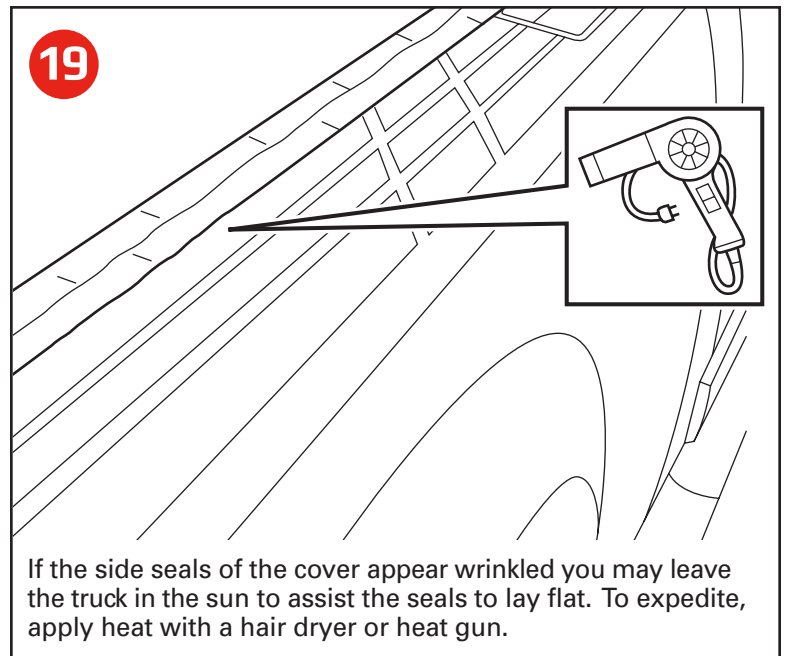
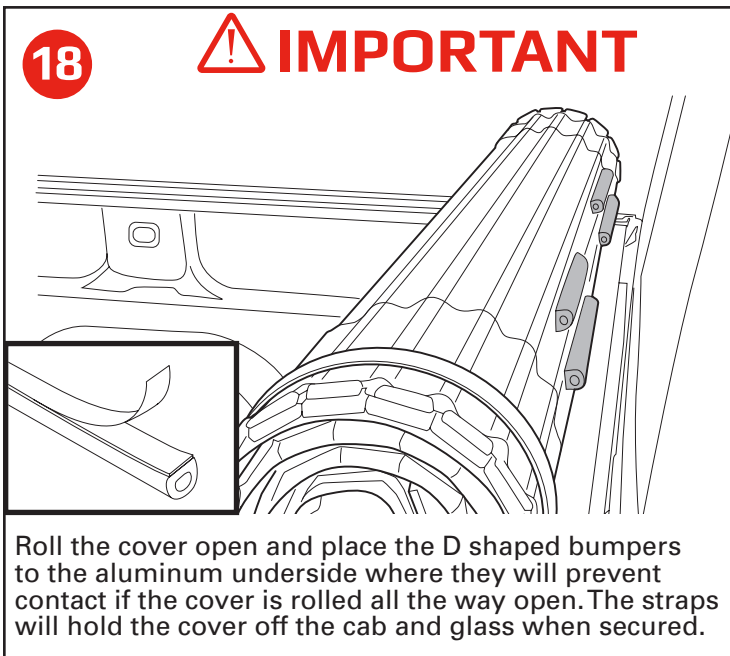
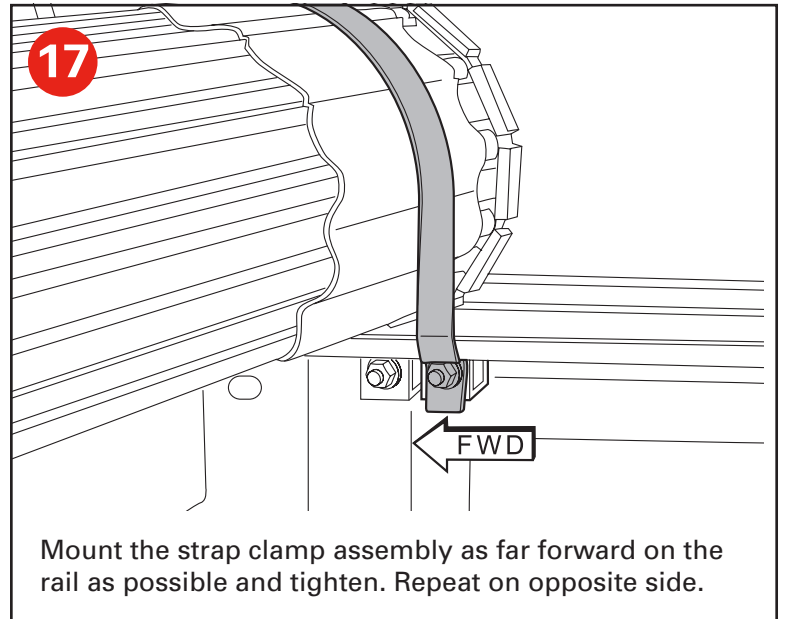
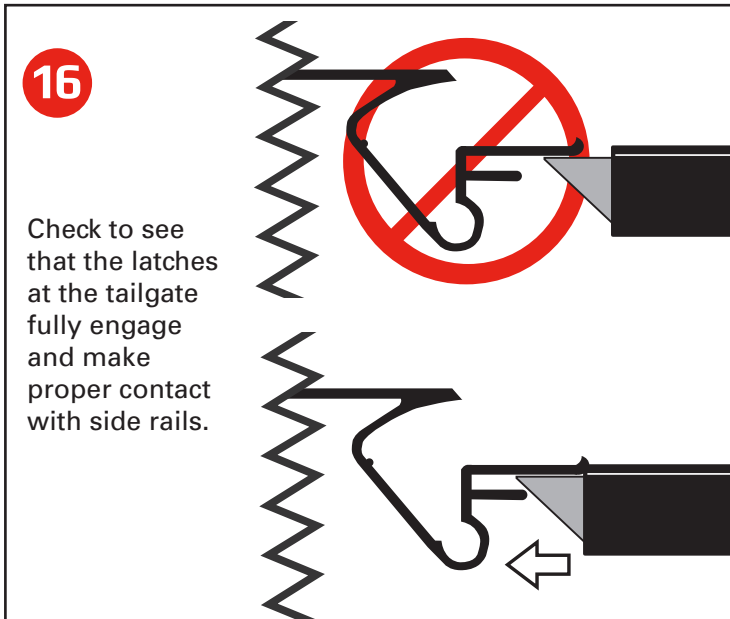
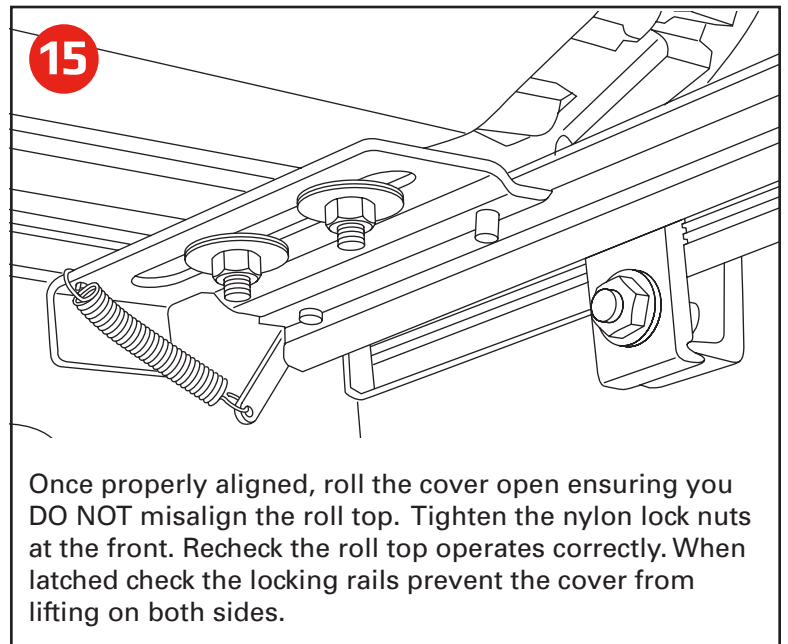
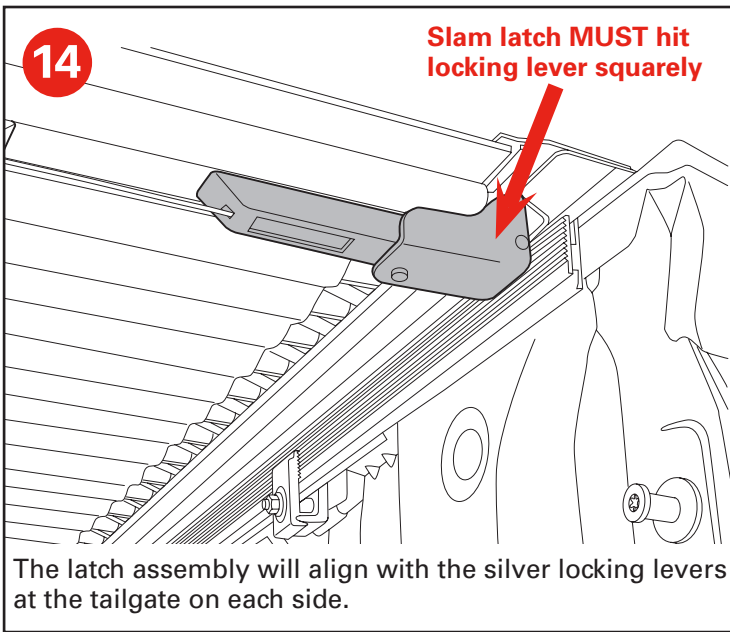

IMPORTANT Safe operation and use

IMPORTANT NOTICE

While driving, cover must be completely flat and secure with BOTH rear latches engaged and in the closed position OR completely rolled up and secured at the cab with the provided straps. **DO NOT DRIVE** with cover partially opened.

Tonneau Cover Positions While Operating Vehicle

Prior to vehicle operation, tonneau cover MUST be properly secured.

CLOSED POSITION (FIG 1)

Cover must be closed and **FULLY LATCHED ON BOTH SIDES** of the tonneau side rails.

OPEN POSITION (FIG 2)

To drive with your tonneau in the open position, simply make use of the provided tie down straps. Roll the cover forward and stop approximately 4" from the cab and insert the strap clips into the buckles at the end of the cover. Ensure BOTH strap clips are fully inserted and tighten the straps with the adjustment locks to ensure the cover doesn't roll or shift during vehicle operation.

Cover Operation

TO CLOSE THE COVER (FIG 3)

Roll the top towards the tailgate and rotate the tail rail downwards towards the rotating locking levers.

WARNING – When closing the cover ensure rear latches on BOTH sides are fully engaged underneath the rails before operating the vehicle.

TO OPEN THE COVER (FIG 4)

Pull downwards on latch release cable located on either side of the cover and rotate tail rail forward and into a rolling motion. Cover should be rolled into a bundle towards the cab of the vehicle and only driven with the cover secured with the provided straps.

DO NOT ATTEMPT TO DRIVE WITH THE COVER IN THE PARTIALLY OPEN POSITION!

ADDITIONAL IMPORTANT OPERATING TIPS

- Tonneau cover MUST be free of foreign material including snow and ice before opening rail top.
- Do NOT tow your vehicle from the rear with the tonneau on your truck.
- Do NOT operate vehicle with objects on top of cover.

FAILURE TO FOLLOW THESE CAUTIONS MAY RESULT IN SEVERE DAMAGE AND WILL VOID YOUR WARRANTY!



Remove any snow or foreign matter before rolling cover.



Do NOT tow your vehicle from the rear with this cover on your truck.

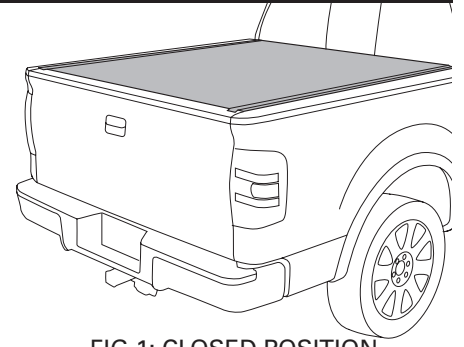

FIG 1: CLOSED POSITION

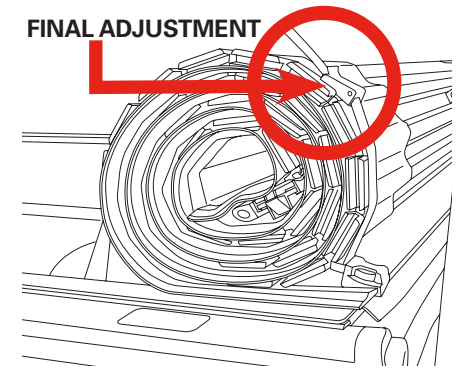

FIG 2: OPEN POSITION

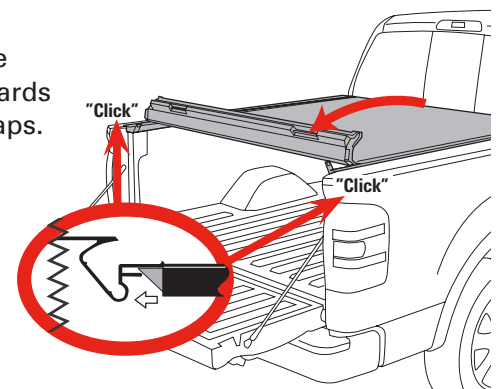

FIG 3: TO CLOSE THE COVER

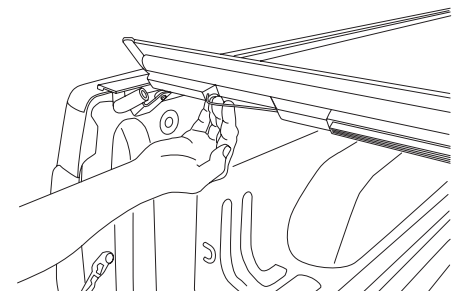

FIG 4: TO OPEN THE COVER

CARE AND MAINTENANCE

REV tonneaus are made from durable materials and require simple care to ensure a long life of performing well and looking great.

Cleaning the Top (Washing)

These stylish covers incorporate OE marine grade vinyl laminated on the top surfaces. Standard automotive soap and water used with a soft sponge or cloth is recommended for cleaning. Shammy dry to prevent water spots and ensure a rich dark finish.

Treating the Vinyl Top

3M™ 303® Aerospace Protectant may be used to keep the vinyl surface clean and protected from the elements and will also remove any water spots that may have developed. 303 Aerospace not only protects against fading, discoloration and cracking from harmful UV rays, but repels dust and stains. Simply spray on and wipe dry for a beautiful, matte finish that protects your cover from road grime and dust. Do not use vinyl conditioners (i.e. Armor All®) because they will shrink the vinyl.

Maintenance

It is recommended that you periodically check that the cover is securely attached to your truck bed. Inspect the clamps and front mounting bolts to ensure they were properly installed and have not come loose or knocked out of adjustment during operation. Covers that are used with high frequency or that are subject to the vibrations and impact from rough roadways can cause the cover to require adjustment.

Lubricating the Latches

It is recommended that you periodically inspect and service the latches on the end of the roll top. Clean away any excess dirt or grime and use a spray lubricate. Ensure the latches move freely in and out to properly engage the side rail and provide proper performance with optimum security. Be careful not to overspray the cover. Wipe away any excess around the latch location.

HARD ROLLING TONNEAU COVER BY REV LIMITED WARRANTY

All Ford part numbers provided by REV Industries are warranted to be free from defects in materials or workmanship on products properly installed per the installation instructions provided with the product. This warranty covers repair or replacement of any defective product at no charge during the applicable warranty period listed below. Labor for replacement or service of defective product is not paid or reimbursed by REV.

WARRANTY PERIOD		
Product which appears on New Vehicle Monroney Label (window sticker)	USA Coverage which matches new vehicle warranty-- Ford - 3 years or 36,000 miles whichever comes first; Lincoln 4 years or 50,000 miles whichever comes first.	OUTSIDE USA Coverage which matches new vehicle warranty Ford - 3 years or 60,000 kilometers whichever comes first; Lincoln 4 years or 80,000 km whichever comes first
Part purchased and installed during or after the original vehicle warranty	Whichever of the following options which provides the greater benefit to the customer: 1) 2 years / unlimited miles or 2) The remainder of the new vehicle warranty	Whichever of the following options which provides the greater benefit to the customer: 1) 2 years / unlimited kilometers or 2) The remainder of the new vehicle warranty

This limited warranty does not cover any damage, defect or malfunction caused by misuse, abuse, accident, improper installation, modification or improper or lack of maintenance. Incidental and consequential damages are not recoverable under this warranty. This warranty offers you specific legal rights. You may have additional or other rights as which vary from state to state or province to province.

If you experience a warranty issue with this product please visit your Ford dealer. If the repair is covered by the warranty above and completed by the dealership, labor is also covered by Ford -- Ford Warranty and Policy – Section 3.

Please note that REV has replacement component parts available to assist consumers and dealers to resolve warranty and non-warranty issues as quickly as possible.

Note to dealer: Ford dealers should contact REV by phone at 818-365-9000 and ask to speak to the REV Covers warranty administrator or by email to: warranty@revcovers.com